

Courses and
up Creek and

- S. 43-W-42
 - S. 32-W-16
 - S. 42-W-5
 - S. 4-W-12
 - S. 24-W-23
- 98.

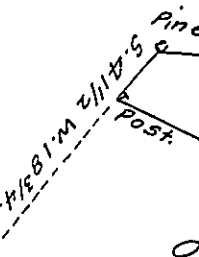

Westmorland -

Geo. Wescott 415^a & Allowce

Ret'd &c. 14th Oct^r 1786.

The
ship Cu
152 Per
Edward
the Pro

To

IN TE